

MULTI-CARTRIDGE FILTER HOUSINGS “M/T SERIES”

Leaflet C-04-02-UK



FLUXA

**Fluxa
Filtri
S.p.A.**

V.le A. De Gasperi, 88/B-20017 Mazzo di Rho (MI)
Tel. 0293959.1 (15 linee)
Fax 0293959.400-440-470
e-mail: info@fluxafiltri.com-www.fluxafiltri.com

Agent for South Italy:
Sire srl - Via Sannio, 9 - 80146 Napoli
Tel. 0817349254 – 0817349310
Fax 0817349317

- The vessels are made completely in stainless steel AISI 304 or AISI 316 L.
- The shell construction with quick bolted cover permits easy cleaning and cartridge changing. These filters are suitable also for filtering dangerous liquids.
- The series “M” feature a cover secured with swing bolts cover to reduce cover removal time.
- The series “T” feature a cover secured with swing bolts with eyenuts.
- The filters are made according to “PED” 97/23/EC.
- If required the filters are made suitable for installation in areas in danger of explosion according to instructions ATEX 94/9/EC.
- The housings of the series M/T can be used to fit filter cartridges open at both ends (DOE) or open at one end only (SOE).
- The series includes filters with output up to 72 mc/h (1200 l/min) and connections up to 4”.
- If required internal / external finishing can be supplied: pickling (standard), electropolishing, brushed, mechanical polishing.



APPLICATIONS

- Industrial process filters
- Prefilters for osmosis
- Drinking and process water
- Paints, inks and coatings
- Solvents and critical fluids
- Hydrocarbons
- Detergents
- Cooling fluids
- Lubricant oils
- Cutting oils

ORDERING INFORMATION								*		
M	SSL	05	30	P	L	UF	050	0	0	00
Type of closure	Material of construction	Filter cartridges		Fastening	Position of connections	Type of connection	Dimension of connections	Options		
		No of stacks	Height							
M = eyenuts T = swing bolts	OOS = AISI 304 SSL = 316L XXX = Special	01 = 1 02 = 2 03 = 3 05 = 5 06 = 6 09 = 9 12 = 12 Etc.	10 = 10" 20 = 20" 30 = 30" 40 = 40" xx = Special	P = Plate with spring and rod T = Rod with plug 3 = cod. 3 7 = cod. 7 8 = cod. 8 9 = cod. 9 X = Special	A = In line Z = Deflected L = at 90° P = Parallel X = Special	UF = UNI fixed flange US = UNI lap joint flange (moulded) AS = ANSI lap joint flange AF = ANSI fixed flange DF = DIN fixed flange DS = DIN lap joint flange NM = threaded NPT m NF = threaded NPT f IM = threaded ISO m IF = threaded ISO f GM = threaded gas m GF = threaded gas f TW = Pipe suitable for welding TC = tri-clover connection BF = Pipe DIN 11851 f BM = Pipe DIN 11851 m	010 = DN10 = Ø 3/8" 015 = DN15 = Ø 1/2" 020 = DN20 = Ø 3/4" 025 = DN25 = Ø 1" 032 = DN32 = Ø 1 1/4" 040 = DN40 = Ø 1 1/2" 050 = DN50 = Ø 2" 065 = DN65 = Ø 2 1/2" 080 = DN80 = Ø 3" Etc.	* TO BE SUPPLIED ON AGREEMENT WITH FLUXA FILTRI: JACKET PROJECT NUMBER FINISH		

M/T SERIES 3		MAX OPERATING PRESSURE	DIMENSIONS					CONNECTIONS			VOLUME Liters	WEIGHT Kg	OUTPUT ** L/H
No stacks	H. cartridges		E/E*	F/F*	H	H*	L	A-B	C	D			
3	10	10 bar @ 60 °C	210/170*	230/270*	120	165	260	1.1/2"	3/8" GF	1/4" GF	10	20	4500
3	20						525				15	22	9000
3	30						795				21	24	13500
3	40						1045				26	26	18000

M/T SERIES 5		MAX OPERATING PRESSURE	DIMENSIONS					CONNECTIONS			VOLUME Liters	WEIGHT Kg	OUTPUT ** L/H
No stacks	H. cartridges		E/E*	F/F*	H	H*	L	A-B	C	D			
5	10	10 bar @ 60 °C	300/265*	220/255*	155	190	280	2"	3/4" GF	1/4" GF	16	27	7500
5	20						545				26	30	15000
5	30						815				36	33	22500
5	40						1065				45	35	30000

M/T SERIES 9		MAX OPERATING PRESSURE	DIMENSIONS					CONNECTIONS			VOLUME Liters	WEIGHT Kg	OUTPUT ** L/H
No stacks	H. cartridges		E/E*	F/F*	H	H*	L	A-B	C	D			
9	20	8 bar @ 60 °C	400/380*	350/370*	215	235	470	3"	3/4" GF	1/4" GF	42	39	27000
9	30						740				57	43	40500
9	40						990				71	46	54000

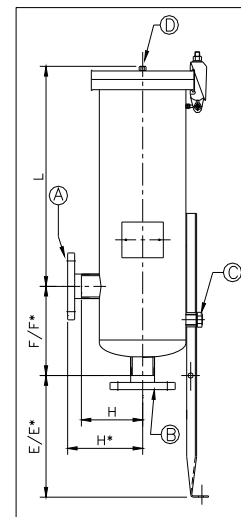

Filters can be supplied with other connections either flanged or threaded

M/T SERIES 12		MAX OPERATING PRESSURE	DIMENSIONS				CONNECTIONS			VOLUME Liters	WEIGHT Kg	OUTPUT ** L/H
No stacks	H. cartridges		E*	F*	H	L	A-B	C	D			
12	30	8 bar @ 60 °C	360	405	265	725	4"	3/4" GF	1/4" GF	81	62	54000
12	40					975				101	68	72000

The max operating temperature depends on the material of the gaskets used:

EPDM (Standard): 120 °C
 BUNA N: 100 °C
 SILICONE: 200 °C
 VITON: 200 °C
 PTFE: 230 °C

* The dimensions refer to filters with flanged connections.

** The nominal outputs shown on the tables above refer to housings containing filter cartridges with high micrometer rating and liquids with viscosity similar to the viscosity of water. Please contact our office for more information.

The housings are suitable to contain Fluxa Filtri filter cartridges with minimum I.D. 25mm and maximum O.D. 68mm.

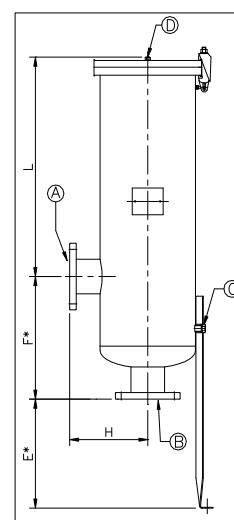

LIMITS TO THE USE OF OUR FILTERS ACCORDING TO DIRECTIVE PED 97/23/EC
 Vessels designed and manufactured in accordance with the Sound Engineering Practice Art.3 par.3 and category I PED

Liquids		M/T 310	M/T 320	M/T 330	M/T 340	M/T 510	M/T 520	M/T 530	M/T 540	M/T 920	M/T 930	M/T 940	M/T 1230	M/T 1240
*** Non dangerous liquids group 2 (PS x V ≤ 10000)	ART. 3 PAR. 3	10 bar	10 bar	10 bar	10 bar	10 bar	10 bar	10 bar	10 bar	8 bar	8 bar	8 bar	8 bar	8 bar
*** Dangerous liquids group 1 (PS x V ≤ 200)	ART. 3 PAR. 3 Category 1	10 bar	10 bar	9 bar 10 bar	7 bar 10 bar	10 bar	7 bar 10 bar	5 bar 10 bar	4 bar 10 bar	4 bar 8 bar	3.5 bar 8 bar	2.8 bar 8 bar	2.3 bar 8 bar	1.9 bar 8 bar

When filtering gases or liquids with vapour pressure > 0.5 bar, please consult our office

PS = Maximum pressure acceptable V = Volume of filter housing

*** Liquids with vapor tension at the max temperature allowed (TS) < 0,5 bar above atmospheric pressure.

The following are the main models of filter cartridges that can be fitted in the filter housings:

- FILOPOR filter cartridges (E-01 Leaflet)
- PROBOND™ filter cartridges (E-05 Leaflet)
- POLIFLO filter cartridges (E-09 Leaflet)
- POLIFLO "S" filter cartridges (E-11 Leaflet)
- DELTAPOR filter cartridges (E-03 E-04 Leaflets)
- Porous materials filter cartridges (E-06 Leaflet)
- FLUSINT porous stainless steel filter cartridges (E-19 Leaflet)
- FLUSINT stainless steel sintered microfibrils filter cartridges (E-20 Leaflet)
- FLUXAMESH stainless steel wire filter cartridges (E-18 Leaflet)
- CARBOPOR activated carbon filter cartridges (E-02 Leaflet)