

BAG FILTER HOUSINGS SERIES SC

Leaflet C-07-01-UK



FLUXA Fluxa Filtri S.p.A.

V.le A. De Gasperi, 88/B-20017 Mazzo di Rho (MI)
Tel. 0293959.1 (15 lines)
Fax 0293959.400-440-470
e-mail: info@fluxafiltri.com - www.fluxafiltri.com

- The filter housings are made from carbon steel or stainless steel. We can supply, on request, special versions with coatings suitable for aggressive fluids.
- They use a clamp cover that is easily removed, reducing time spent on bag change-out.
- They are manufactured following the requirements of P.E.D. 97/23/EC Directive. On request they can be manufactured following the requirements of ASME VIII Div.1.
- The standard models are suitable for pressures up to 10 bars. Special models according to client's requirements can be supplied.
- The series includes single bag filter housings for outputs up to 40 cm/h and multiple bag filter housings for outputs up to 960 cm/h (24 filter bags).
- For filter bag sizes 05, 09, 1, 2 both with metal rings or with printed plastic rings.
- The single bag filter housings are normally supplied with outlet on bottom of the housing so that the filter can be totally drained. In the multiple bag filter housings the connections are on line. The standard single bag filter housings, suitable for bags size 1 and size 2, have stainless steel legs, adjustable as to height, whilst single bag filter housings model 05-09 are supplied without legs. On request other versions can be supplied.
- If required, internal/external finishing can be supplied: pickling (standard), electropolishing, brushed, mechanical polishing.

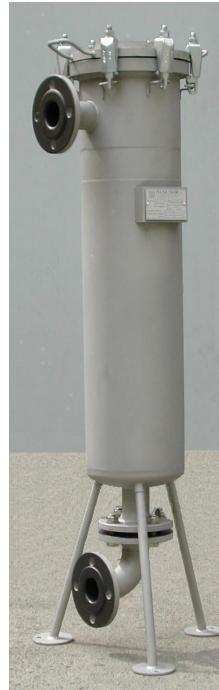

APPLICATIONS

- Industrial process filters
- Prefilters for osmosis
- Drinking and process water
- Paints, inks and coatings
- Solvents and critical fluids
- Hydrocarbons
- Detergents
- Cooling fluids
- Lubricant oils
- Cutting oils

ORDERING INFORMATION

ORDERING INFORMATION								*		
SC	SSL	05	2	T	Z	UF	065	0	0	00
	Material of construction	Filter bags		Type of cover	Position of connections	Type of connections	Size of connections	Options		
		N° Bags	Model of bag							
	OOS = AISI 304 SSL = 316L XXX = Special	01 = 1 02 = 2 03 = 3 04 = 4 05 = 5 06 = 6 08 = 8 10 = 10 12 = 12 16 = 16 Etc.	1 = SIZE 1 2 = SIZE 2 5 = SIZE 05 9 = SIZE 09 X = Special	B = Bolted closure T = Swing bolts M = Swing screw clamp X = Special	A = In line Z = Deflected L = at 90° P = Parallel X = Special	UF = UNI fixed flange US = UNI lap joint flange (moulded) AS = ANSI lap joint flange AF = ANSI fixed flange DF = DIN fixed flange DS = DIN lap joint flange NM = threaded NPT m NF = threaded NPT f IM = threaded ISO m IF = threaded ISO f GM = threaded gas m GF = threaded gas f TW = Pipe suitable for welding TC = tri-clover connection BF = Pipe DIN 11851 f BM = Pipe DIN 11851 m	010 = DN10 = Ø 3/8" 015 = DN15 = Ø 1/2" 020 = DN20 = Ø 3/4" 025 = DN25 = Ø 1" 032 = DN32 = Ø 1 1/4" 040 = DN40 = Ø 1 1/2" 050 = DN50 = Ø 2" 065 = DN65 = Ø 2 1/2" 080 = DN80 = Ø 3" 100 = DN100 = Ø 4" 125 = DN125 = Ø 5" 150 = DN150 = Ø 6" 200 = DN200 = Ø 8" 250 = DN250 = Ø 10" 300 = DN300 = Ø 12" Etc.	* TO BE SUPPLIED ON AGREEMENT WITH FLUXA FILTRI: JACKET PROJECT NUMBER FINISH		

TECHNICAL DATA

SINGLE BAG FILTER SERIES			MAX OPERATING PRESSURE	DIMENSIONS ¹					CONNECTIONS ²		VOLUME ¹ Liters	WEIGHT Kg	OUT/PUT ³ Liters/h
Model	N° Bags	Type bag		E/E*	F/F*	H	H*	L	A-B	C			
SC...05	1	05	10 bar @ 100°C	315	75	105	-	390	1. 1/2"	1/4"	4	5	6.000
SC...09	1	09		450	75	105	-	525	1. 1/2"	1/4"	5	6	12.000
SC...11	1	1		400/375*	520/545*	155	190	115	2"	1/4"	22	21	20.000
SC...12	1	2		400/375*	860/885*	155	190	115	2"	1/4"	34	25	30.000

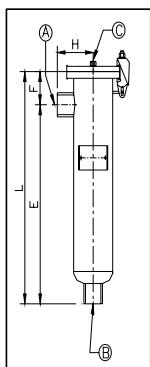

Mod. SC...05, SC...09

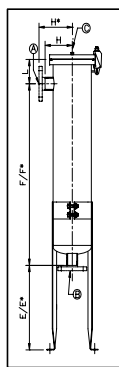

Mod. SC...11, SC...12

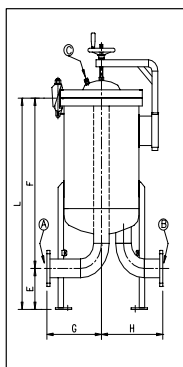

Multiple bag filters
In line connections (A)

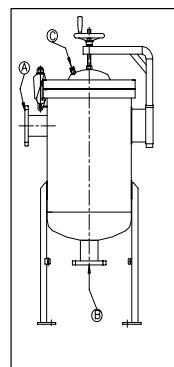

Multiple bag filters
Connections at 90° (L)

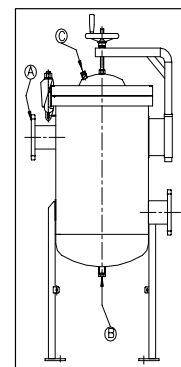

Multiple bag filters
Deflected connections (Z)

MULTIPLE BAG FILTER SERIES			MAX OPERATING PRESSURE	DIMENSIONS ¹					CONNECTIONS ²		VOLUME ¹ Liters	WEIGHT Kg	OUT/PUT ³ Liters/h
Model	N° Bags	Type bag		E	F	L	G	H	A-B	C			
SC...41	4	1	10 bar @ 60°C	250	700	950	400	450	4"	1/2"	120	150	80.000
SC...42	4	2		250	1040	1290	400	450	4"	1/2"	200	165	120.000
SC...52	5	2		250	1365	1290	400	450	5"	1/2"	250	205	150.000
SC...62	2	2		250	1180	1430	500	550	6"	1/2"	300	235	180.000

¹ Dimensions and volumes are approximate

² Filters can be supplied with other connections either flanged or threaded

³ The nominal outputs shown on the tables above refer to liquids with the same viscosity as water and bags with a retention of 25 micron

The max operating temperature depends on the type of gaskets used:

EPDM (Standard):	120°C
BUNA N:	100°C
SILICONE:	200°C
VITON:	200°C
PTFE:	230°C

LIMITS TO THE USE OF OUR FILTERS ACCORDING TO RULES PED 97/23/EC

Art. 3 par. 3 – Machines built in a workmanlike way and according to rule PED 97/23/EC

LIQUID	SC ...05	SC ...09	SC ...11	SC ...12	SC ...41	SC ...42	SC ...52	SC ...62
*** Non dangerous liquids group 2 (PS x V ≤ 10000)	10 bar art. 3 par. 3	10 bar art. 3 par. 3	10 bar art. 3 par. 3	10 bar art. 3 par. 3	10 bar art. 3 par. 3	10 bar art. 3 par. 3	10 bar art. 3 par. 3	10 bar art. 3 par. 3
*** Dangerous liquids group 1 (PS x V ≤ 200)	10 bar art. 3 par. 3	10 bar art. 3 par. 3	9 bar art. 3 par. 3	5,5 bar art. 3 par. 3	10 bar Class I PED	10 bar Class I PED	10 bar Class I PED	10 bar Class I PED
			10 bar Class I PED	10 bar Class I PED				

When filtering gas or liquids with vapour tensions > 0.5 bar, please consult our office.

PS = Maximum pressure acceptable

V = Volume of filter housing

*** Liquids with vapour tension at the max temperature allowed (TS) < 0,5 bar above atmospheric pressure.

ACCESSORIES ON REQUEST:

A) Evacuation balloon

B) Bag positioner

C) Insert of magnetic candles

D) Reinforced basket

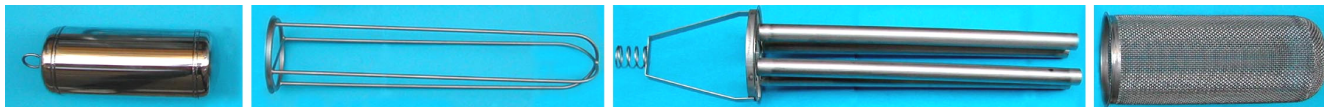

Consult the following leaflet to obtain more information:

- > Bag leaflet : for information concerning filter bags
- > PB 100 leaflet: for information concerning basket
- > FH bag leaflet: for information concerning non dangerous liquids
- > Magnetic leaflet: where it is necessary to put magnetic candles

